

# PRODUCT DATA SHEET

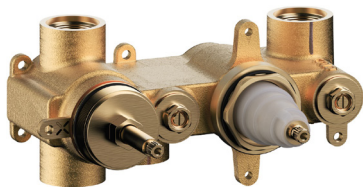

## PRODUCT CODE

WLBP1501R

## RANGE

Thermo SV

## DESCRIPTION

2 Way Diverter Valve Body With No Collars

WEBSITE LINK [Click Here](#)

CATEGORY	Brassware
WARRANTY DETAILS	15 Years
PRIMARY MATERIAL	Brass
INSTALL TYPE	Wall Mounted
PRODUCT WIDTH MM	181
PRODUCT HEIGHT MM	82
PRODUCT NET WEIGHT KG	2.4
MINIMUM PRESSURE (BAR)	0.5
MAX WORKING PRESSURE (BAR)	5

STANDARDS	BS EN 1111:2017
APPROVAL	WRAS:- 2203300 KIWA Reg 4:- 2201704 KIWA TMV2:- 2203756
NUMBER OF OUTLETS	2
NUMBER OF FUNCTIONS	2
HEADWORK	Diverter and Thermostatic Cartridge
SWIVEL SPOUT	No
INLET CONNECTIONS THREAD	G3/4"
OUTLET CONNECTIONS THREAD	G3/4"
WASTE INCLUDED	No
ANTI-SCALD	Yes
ENERGY SAVING	No
SHOWER HOSE & HANDSET ARE INCLUDED	No

PRESSURE (BAR)	0.2	0.5	1	2	3	4	5
PRIMARY FLOWRATE		14.05	20.62	31.06	38.13		50.47
HANDSET FLOWRATE							
MASSAGE FLOW RATE							
AIR FLOW RATE							
WIRE FLOW RATE							
WATERFALL FLOW RATE							
MIST FLOW RATE							
HANDSPRAY FLOW RATE							

## TECHNICAL DIMENSIONS

Dimensions in mm unless otherwise specified.

Tolerances (per material type) apply.

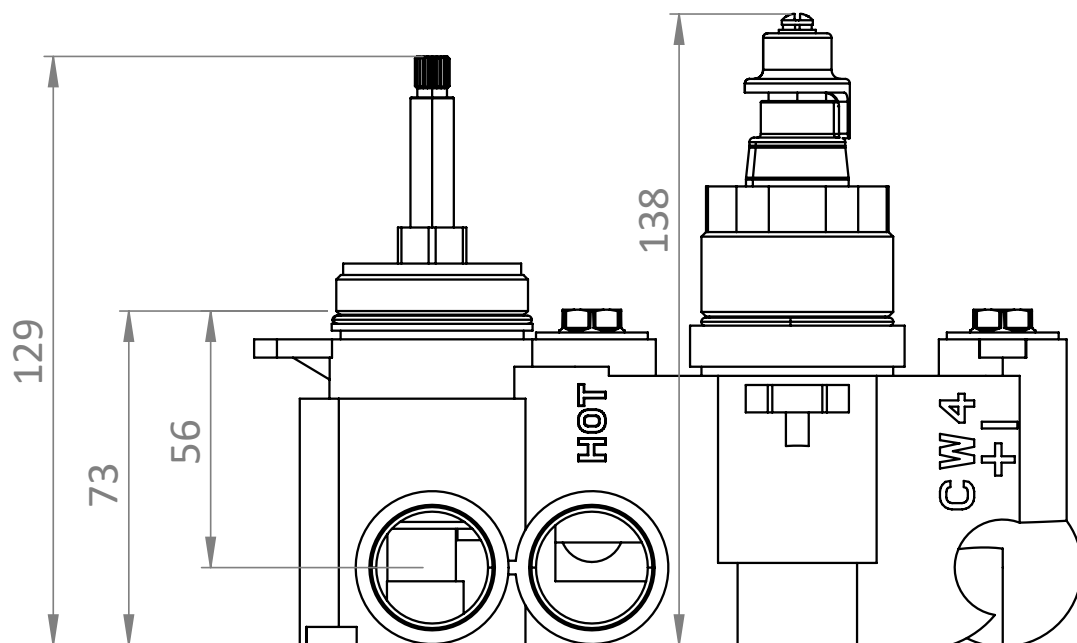
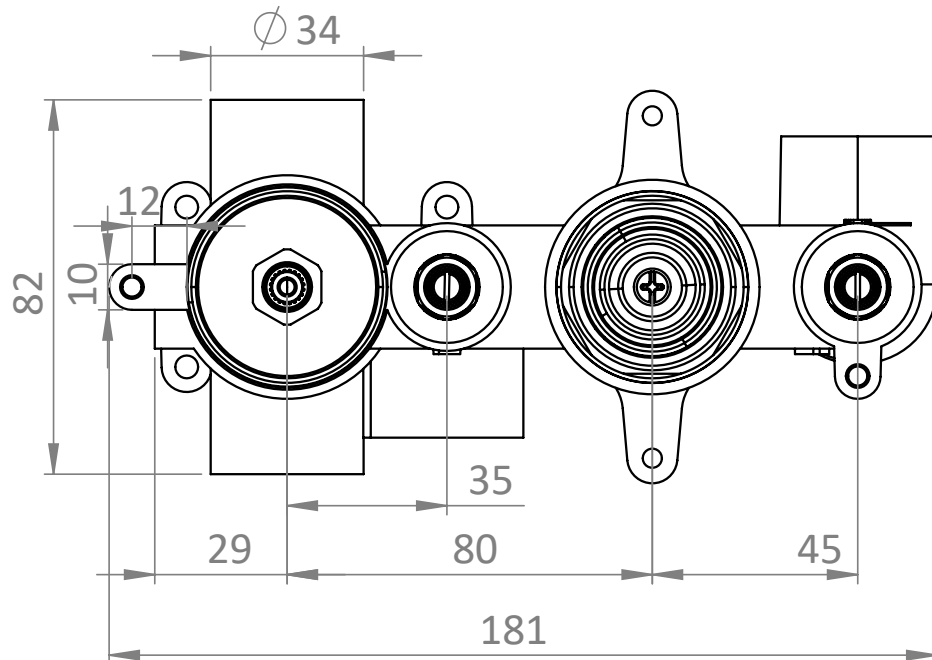

## SPARES LIST

Only the parts labelled are available as spares.

SPARES AVAILABLE UPON REQUEST