

Measurements in millimetres mm

Information updated July 2020

Tel 0345 873 8840

crosswater[™]

KAI 500mm

TWO DRAWER FURNITURE

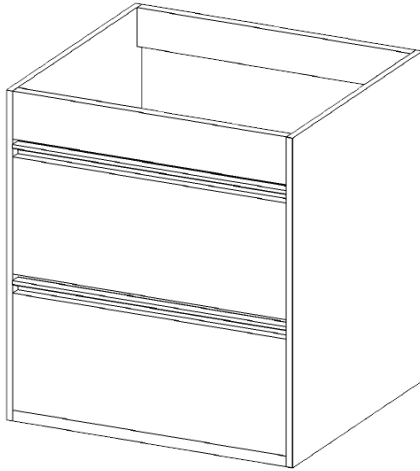

TECHNICAL DATA

CODE No UNIT	KL5200D
Required Basins	DE0002SCW+
Required Worktop	KL5000TWG
Recommended use:	Domestic, residential
Dimension Unit	w 503 x d 454x h 480mm
Dimension basin	w 510 x d 460 x h 20mm
Dimension worktop	w 510 x d 460 x h 19mm
Installation:	Wall Hung
Materials:	Carcass and drawers front 16mm Melamine faced board Drawer set 16mm Melmaine faced board
Specification:	Full extension soft close drawer - 25kg weight capacity
Weight:	19
Fitting:	Wall hangers integrated into carcass Wall brackets supplied
Required Fitting:	BSW0103WG Click Clack Basin waste with Ceramic Cover
Advised Fitting:	Space saving 50mm seal trap BTR0510W
Warranty	10 years on furniture, lifetime on ceramic basin

SPECIFICATION

Installation Information: The intended installation wall needs to be strong enough for the weight of the furniture and basin. Wall fixings for solid walls included.
Integral anodised aluminium handle

Furniture Colours:

White gloss lacquer	KL5200DWG
Grey Gloss Lacquer	KL5200DGG
Grey Oak Décor	KL5200DGO

Standards EN 312 and EN 14322.

FRONT VIEW

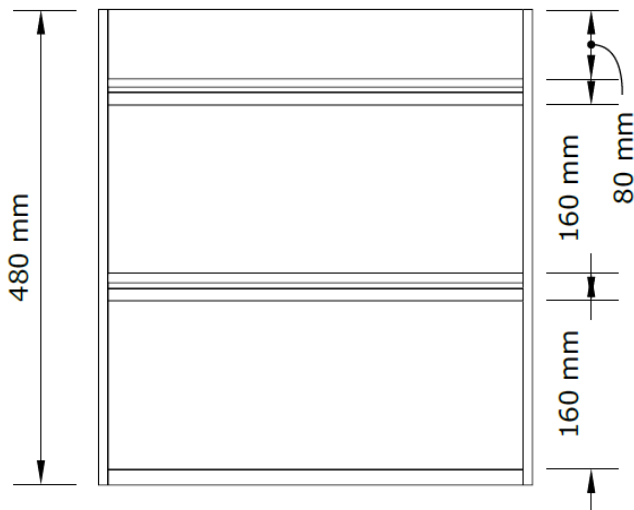

PLAN VIEW

