

PRODUCT DATA SHEET

crosswater[®]



PRODUCT CODE

OXPDSPBZC0800

RANGE

Optix 10

DESCRIPTION

Optix Side Panel for Pivot Inline 800
Brushed Bronze

CATEGORY	Showering
WARRANTY DETAILS	Lifetime
COLOUR	Brushed Bronze
FINISH APPLICATION	PVD
PRIMARY MATERIAL	Glass
INSTALL TYPE	Wall Fixed
PRODUCT HEIGHT MM	2000
PRODUCT LENGTH MM	800
PRODUCT NET WEIGHT KG	44
STANDARDS	EN14428

HANDING SHOWERING	Universal
GLASS THICKNESS	10mm
EASY CLEAN	Yes
MAGNETIC DOOR STRIPS	Yes
POWER SHOWER PROOF	Yes
NUMBER OF DOORS	1
SOFT CLOSING DOORS	No
SAFETY GLASS	Yes
REMOVABLE SEALS	Yes
QUICK RELEASE ROLLERS	No
WET ROOM COMPATIBLE	Yes
DOOR A INFORMATION	Side panel
DOOR ADJUSTMENT	760-780mm

TECHNICAL DIMENSIONS

Dimensions in mm unless otherwise specified.

Tolerances (per material type) apply.

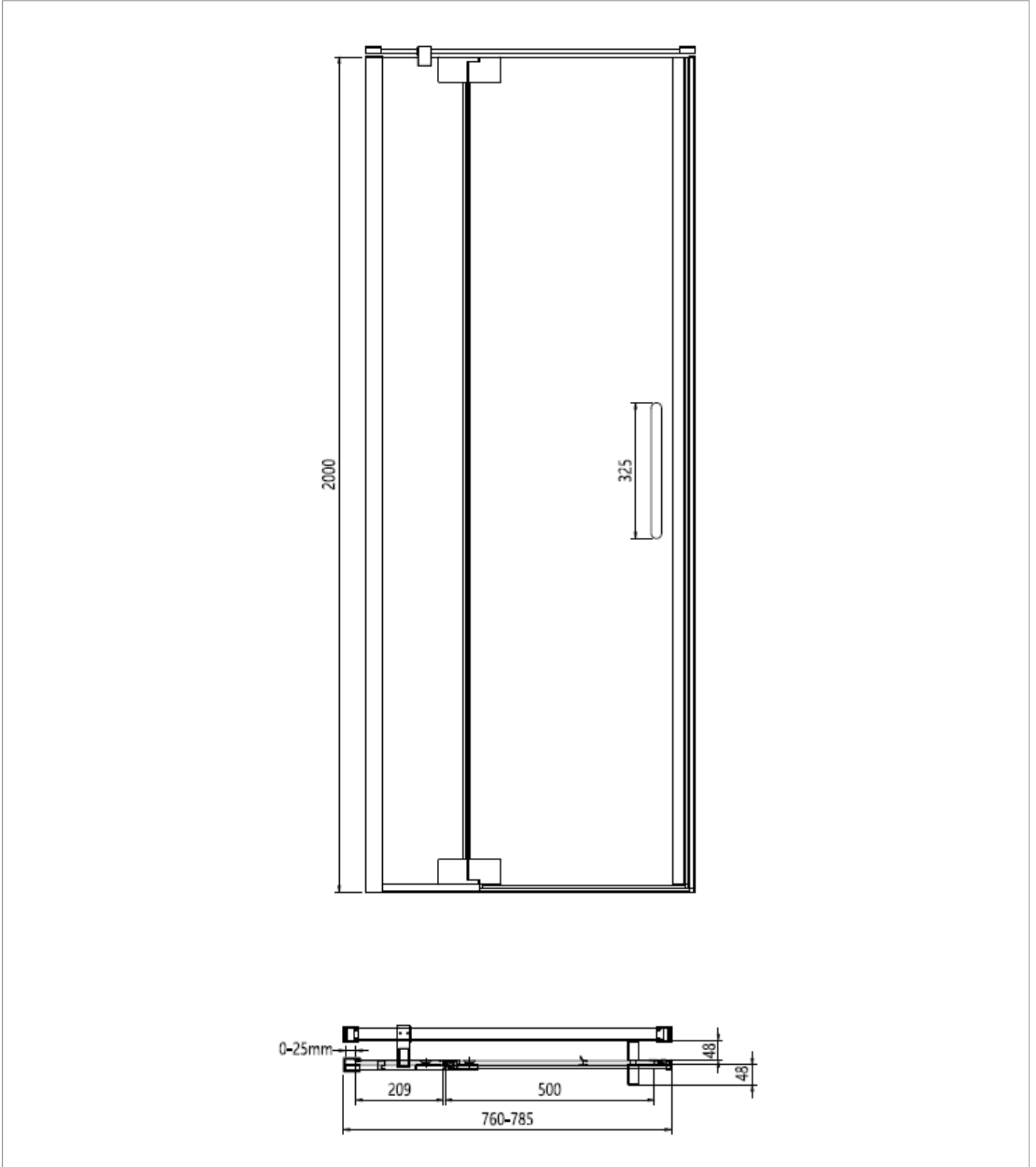

SPARES LIST

Only the parts labelled are available as spares.

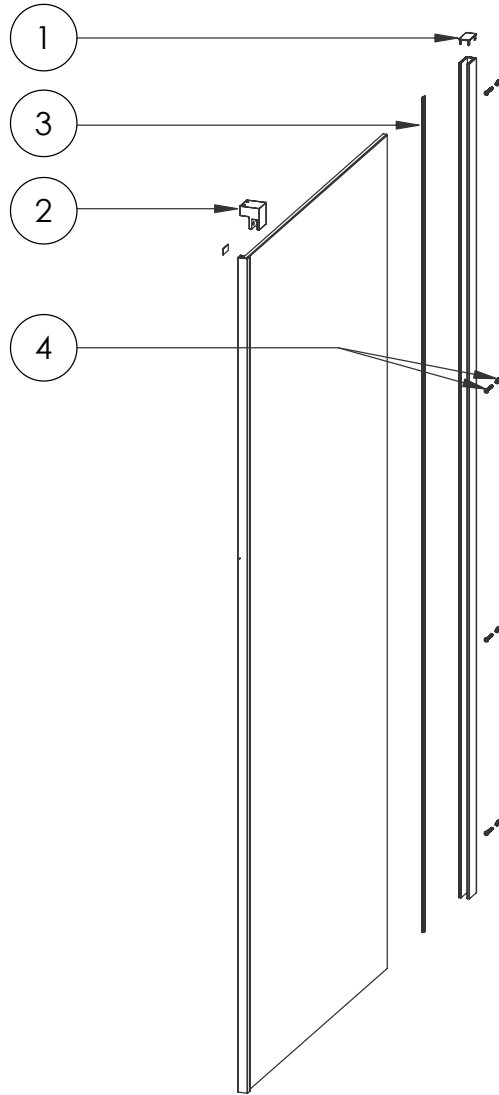

NUMBER	PART CODE	DESCRIPTION
1	OPPROFILECAP	Optix Wall Profile Cover Caps
2	OPTIXINSTALLKIT	Optix Installers Tool Kit
3	OPWALLPROFILESEAL	Optix Wall Profile Seal
4	OXPIVOTINSPACKT	Optix Blister Pivot Inl Side Slate
	OXPIVOTINSPACKBZ	Optix Blister Pivot Inl Side Brushed Bronze