

Measurements in millimetres mm

Information updated March 2021

Tel 0345 873 8840

crosswater[™]



TECHNICAL DATA

| | |
|------------------------|---|
| CODE No | SE6117CW+ Standard Euro white |
| Seat required | SE6105W |
| Recommended use | Domestic, hotel, residential |
| WC Type | Floor Standing, fully back to wall |
| Rim type | Rimless |
| Material | Vitreous China |
| Outlet | Horizontal, vertical 180mm |
| Flush | Washdown 4.5/3l dual flush |
| Standards | EN997-CL2-4.5/3l |
| Fixing | Floor fixings included, spares code FX6007EA1 |
| Weight | WC 26.7kg; Seat 2.5kg |
| Warranty | 2 years, 25 years on ceramic if registered; 2 years on seat |

SPECIFICATION

Floor Standing washdown WC pan
EN 997-CL2-4.5/3l, EN 33, dimensions w 360 x h 420 x d 520 mm
Horizontal outlet,
Fully back to wall, concealed trap
Special feature: concealed surfaces directing water are fully glazed throughout, no rim, vacuum checked

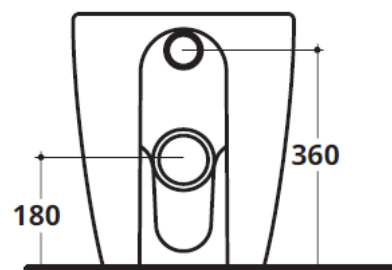
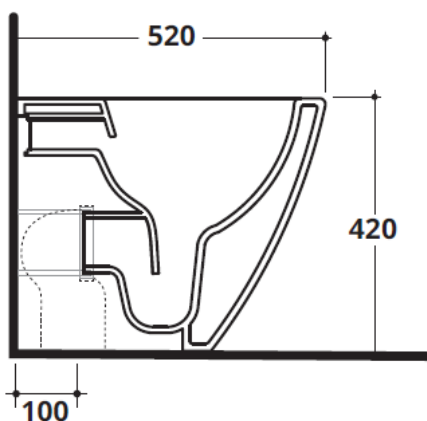
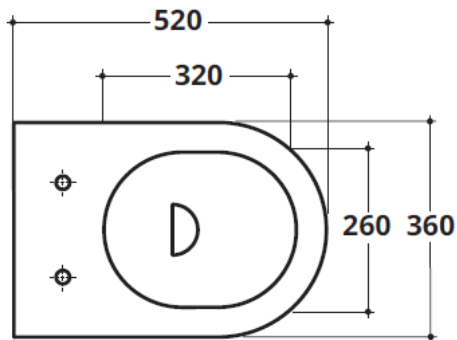

Sizes detailed could have a variation of about +/-5 % due to the changes to material characteristics during the firing processes. Exact measurements for individual installations can only be taken from the finished ceramic