

Navona Counter/Wall Hung Basin

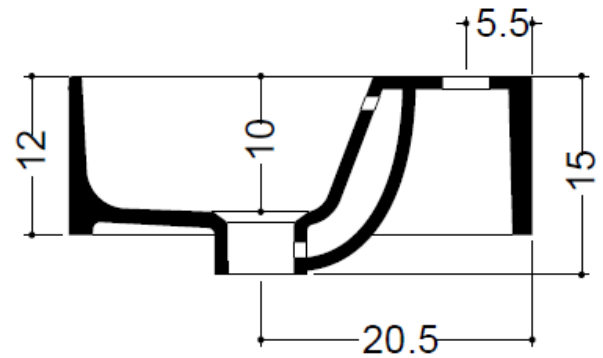

TECHNICAL DATA		SPECIFICATION
CODE No	CT08801SCW	Countertop or Wall hung basin EN 31/EN 14688 – CL 0 Dimensions w 450 x d 350 x h 120mm 1 centre tap hole, overflow Special feature: overflow channel glazed. The back of the basin is unglazed and feature wall hanging holes.
Compatible with:	Wall Mount Installation only	
Recommended use	Domestic, hotel, residential	
Material	Fine Fire Clay	
Standards	BS EN 14688 – CL 0 BS EN31	
Colour	White only	
Specification	1 centre tap hole Over flow	
Fixing	Wall Mounted (2x hanging holes) fixing bolts included	
Weight	12kg	
Warranty	2 years (25 years when registered)	

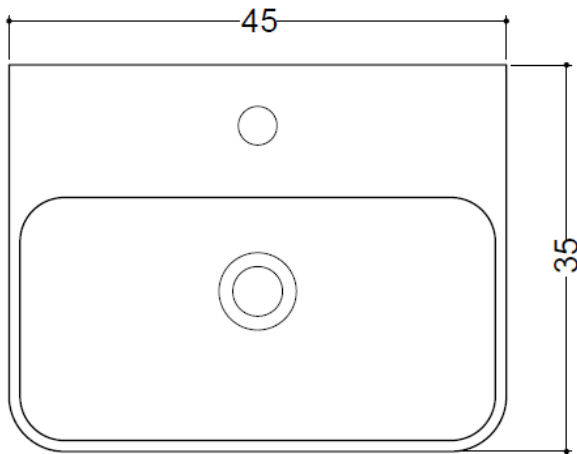
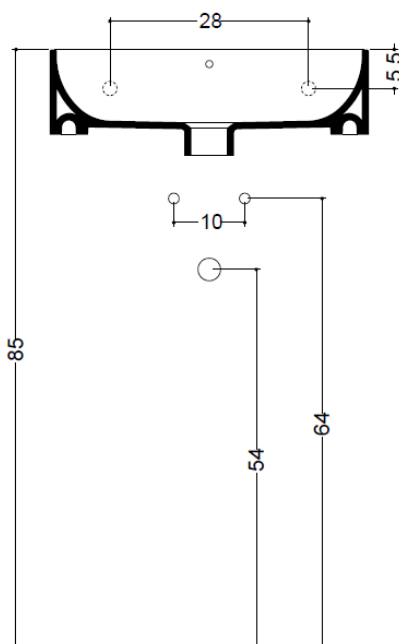

Wall hung installation details

Sizes detailed could have a variation of about +/- 5 % due to the changes to material characteristics during the firing processes. Exact measurements for individual installations can only be taken from the finished ceramic